

REVISIONS				
ZONE	REV.	DESCRIPTION	DATE	APPROVED
	A	INITIAL RELEASE	11/26/13	MSC
	B	SHIFTED ELECTRICAL OUTLET DOWN BY 2"	1/19/14	MSC
	C	ADDED NOTE THAT ELECTRICAL OUTLET IS TO BE ON CLEAN ROOM SIDE	2/5/14	MSC
	D	ADJUSTED OPENING LOWER EDGE TO 36" ELEVATION	4/8/14	MSC
	E	ADDED SECTION VIEW A-A	8/18/16	MSC

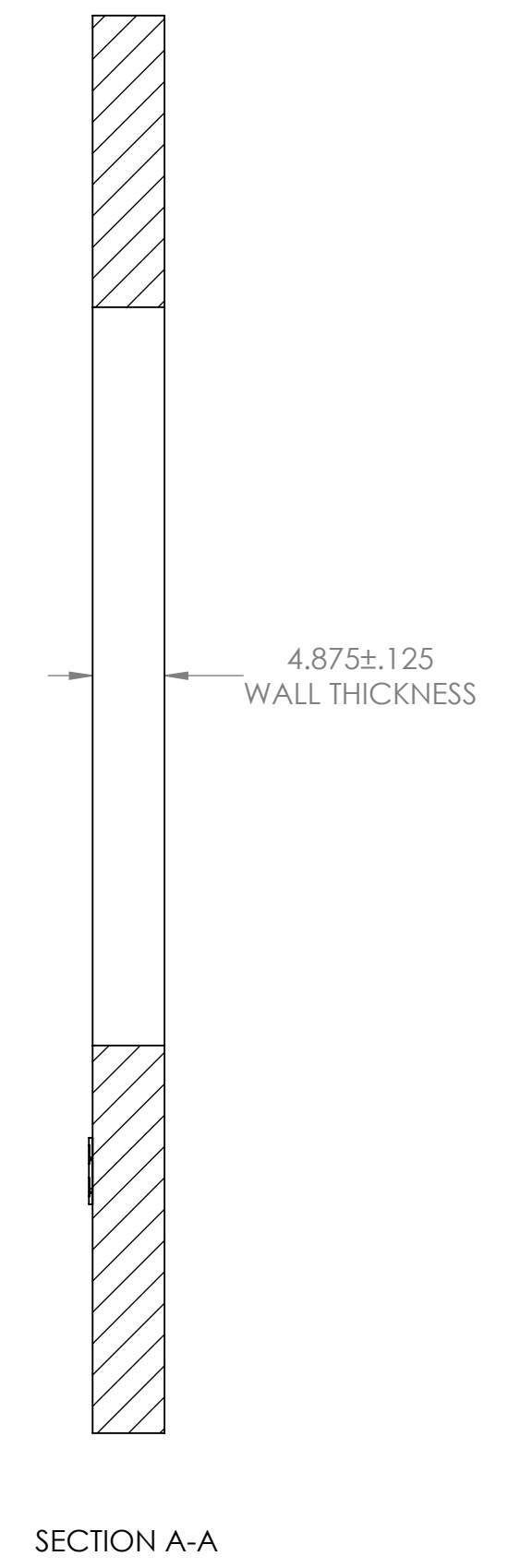
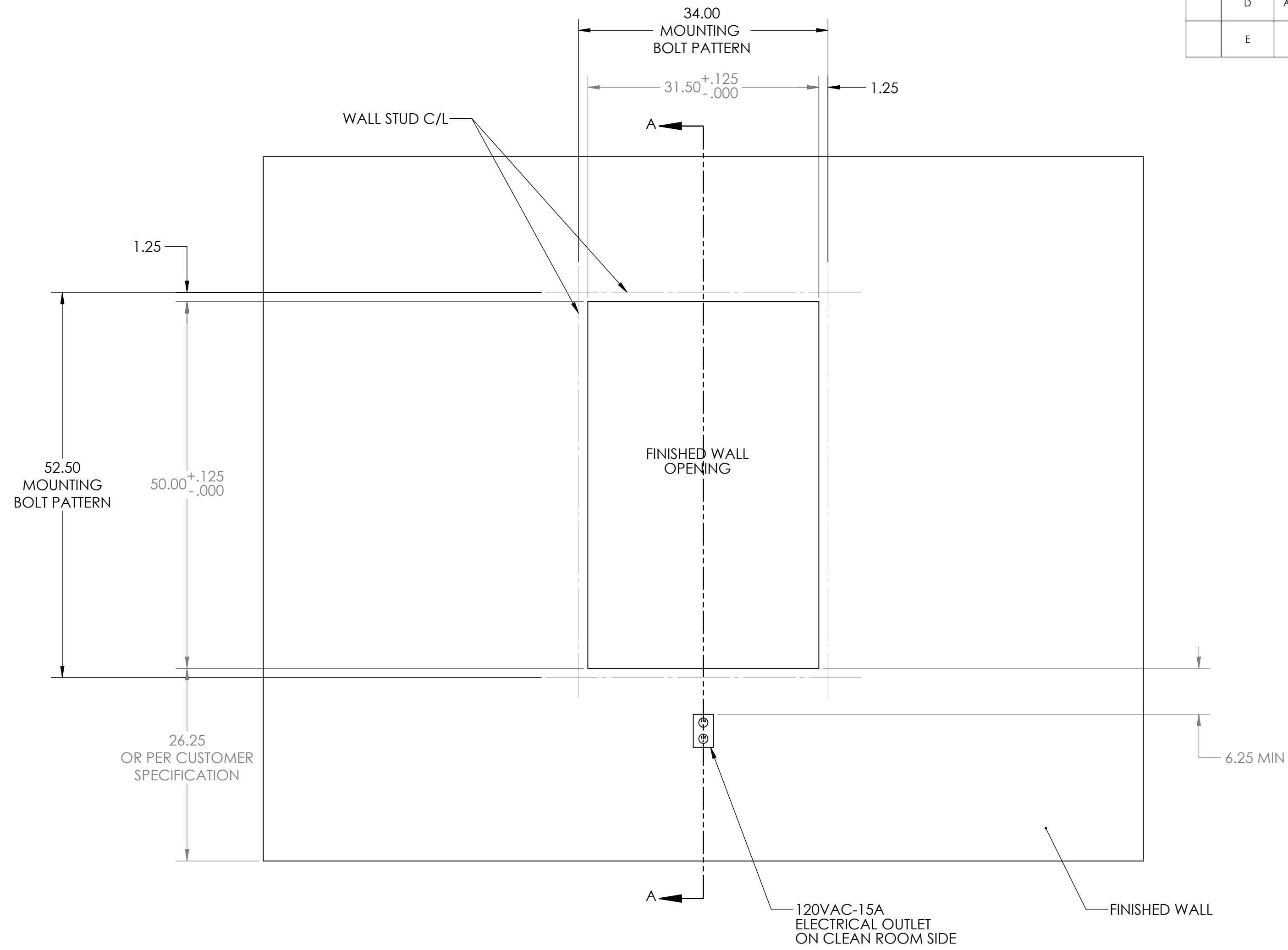

- NOTES:
1. WALL STUDS SHOULD BE CENTERED ON THE BOLT PATTERN CENTERLINES TO SUPPORT THE PASS-THRU WINDOW
 2. 120VAC-15A ELECTRICAL OUTLET IS REQUIRED TO POWER THE UNIT
 3. 6-FOOT POWER CORD IS SUPPLIED WITH THE WINDOW
 4. OVERALL WALL THICKNESS SHOULD BE 4.875 +/- .125"

PROPRIETARY AND CONFIDENTIAL
 THE INFORMATION CONTAINED IN THIS DRAWING IS THE SOLE PROPERTY OF CLEAN ROOM DEVICES, LLC. ANY REPRODUCTION IN PART OR AS A WHOLE WITHOUT THE WRITTEN PERMISSION OF CLEAN ROOM DEVICES, LLC IS PROHIBITED.

UNLESS OTHERWISE SPECIFIED:		NAME	DATE	CLEAN ROOM DEVICES, LLC	
DIMENSIONS ARE IN INCHES		DRAWN	MSC		11/26/13
TOLERANCES:		CHECKED			
FRACTIONAL ±1/16		ENG APPR.			
ANGULAR: MACHINED ±0.5°		MFG APPR.			
BEND ±2°		Q.A.			
TWO PLACE DECIMAL ±.01		COMMENTS:			
THREE PLACE DECIMAL ±.005					
INTERPRET GEOMETRIC TOLERANCING PER: ANSI Y14.5					
MATERIAL					
SEE NOTES					
NEXT ASSY	USED ON				
FINISH					
DO NOT SCALE DRAWING					

TITLE:	FINISHED WALL OPENING, CRD325		
SIZE	DWG. NO.	REV	
C	325-002	E	
SCALE: 1:12	WEIGHT:	SHEET 1 OF 1	