

CLEAN ROOM DEVICES, INC.

CRD201 TIME DELAY TUBING EXPANDER

OPERATIONS MANUAL

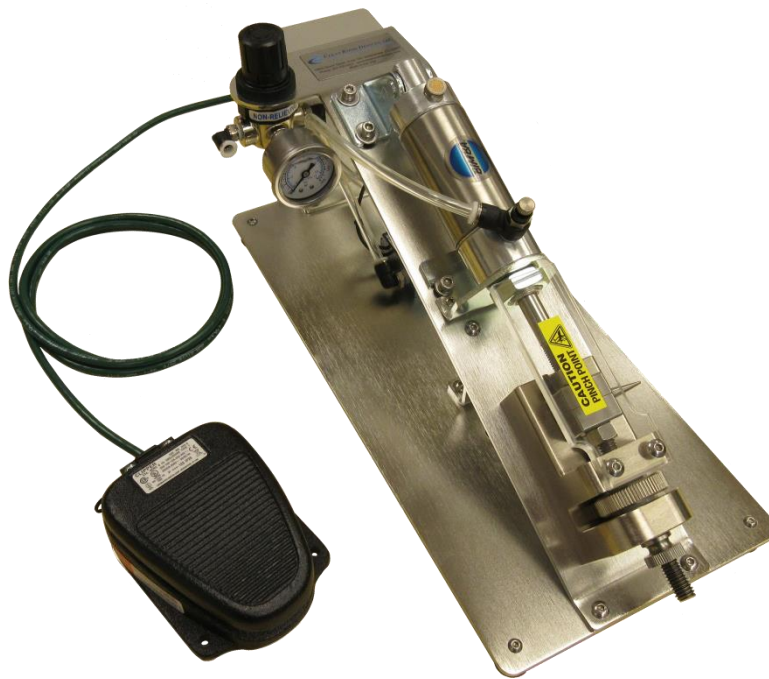

CRD201

Clean Room Devices, Inc.
10855 Dover St. Suite 100
Westminster, CO 80021



ORIGINAL INSTRUCTIONS

VERSION 2.6

LAST EDITED 08.11.2022

cleanroomdevices.com

Table of Contents

- Table of Contents.....2
- 1.0 General Product & Safety Information.....3
 - 1.1 Product Information
 - 1.2 Safety Information
- 2.0 Installation.....4
 - 2.1 Air Supply
 - 2.2 Electrical
 - 2.3 Connection Setup
- 3.0 Operation.....5
 - 3.1 Jaw Adjustment
 - 3.2 Setting Time Delays
 - 3.3 Expanding Operation
 - 3.4 Jaw Installation and Removal
- 4.0 Troubleshooting.....13
- 5.0 Maintenance.....13
 - 5.1 Periodic Cleaning (annually)
 - 5.2 Tools List
- 6.0 Product Specifications.....14
- 7.0 Durometer Scale.....14
- 8.0 Wiring Schematic.....15
- 9.0 Parts List.....16
- 10.0 Warranty.....17
 - 10.1 Warranty
 - 10.2 Warranty period

1.0 General Product & Safety Information

1.1 Product Information

- Unit is designed to expand flexible tubing up to a durometer of Shore A 85 (Shore D 35), including any non-metallic braided materials.
- The minimum/maximum inside tube diameter is .040” – 1/2”
- The standard jaw sets are universal and are designed to be used with an inside diameter range of .040” to 1/2". Other jaw sets are available that are optimized for a specific size (see accessories page at www.cleanroomdevices.com or call Clean Room Devices, Inc.).
- The device features simple yet reliable jaw adjustment, which can be made by the operator.
- The device features a calibrate-able pressure gage conveniently mounted for additional process control.
- The device features independently adjustable expansion and interval period adjustments from 0.5-5 seconds, allowing for repeatability of operation.
- The serial number for the device is located on the bottom, rear of the base.



Figure 1.1

1.2 Safety Information

- This product uses an air cylinder and foot pedal to pneumatically actuate the expanding jaws. The unit is not intended to expand anything other than flexible tubing.

WARNING

Avoid placing your fingers between the upper jaw block and the air cylinder mounting bracket while operating unit, sufficient pressure exists to cause personal injury.

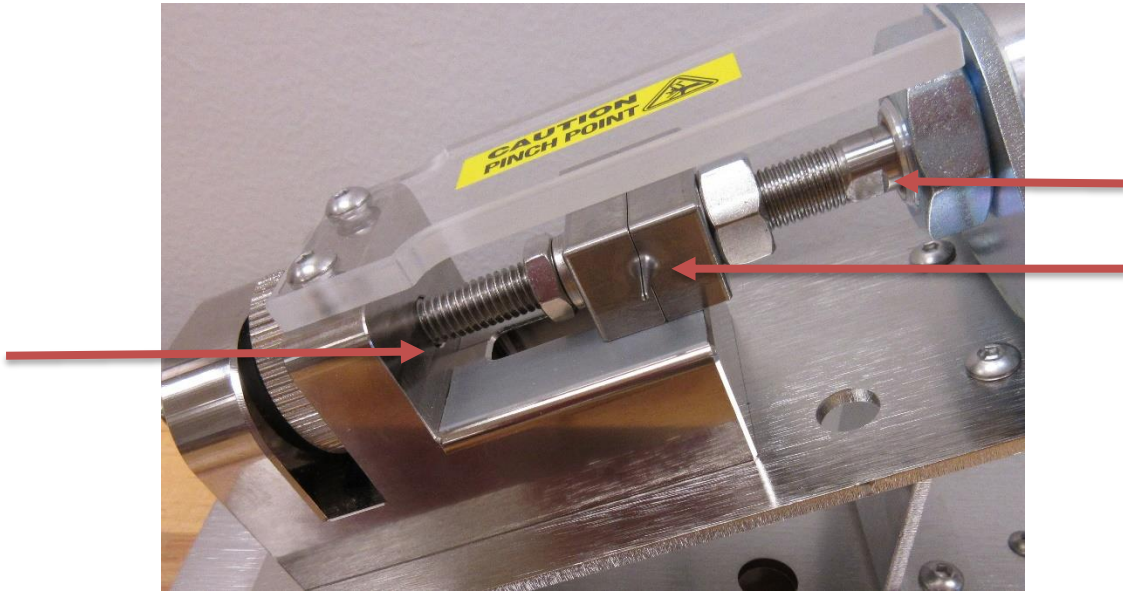

Arrows indicate pinch points

2.0 Installation

Ensure all five (5) rubber feet are completely stabilized on your work surface prior to applying air pressure to the unit.

2.1 Air Supply

- Connect a 1/4" OD air supply hose to the inlet on the pressure regulator. The air supply should be free of moisture and contaminants and provide a minimum of 100 psi.
- The regulator on the unit should be set to 80-100 psi.

2.2 Electrical

- 120 to 240V AC power supply required for operation. The unit will come with the appropriate 24 VDC power supply.

2.3 Connection Setup

- Setting up the connections on the CRD201 is a simple task. Refer to *Figure 2.3.1* below when making all connections to the back panel.

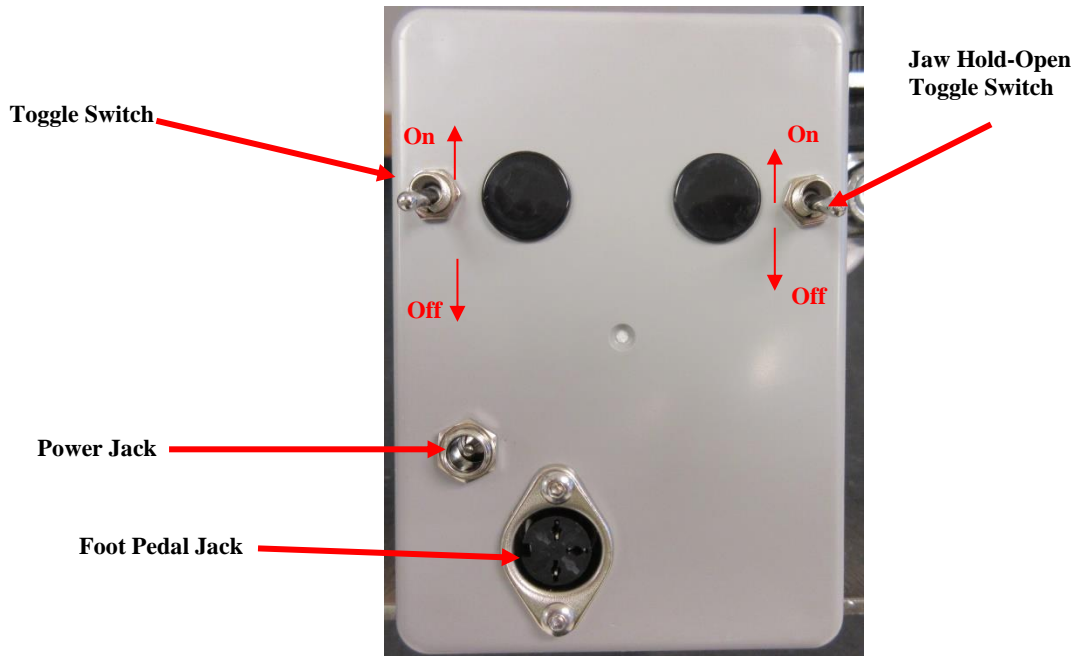

Figure 2.3.1

3.0 Operation

3.1 Jaw Adjustment

- Start by using a 9/16” wrench to loosen the 3/8” hex nut at the bottom end of the lower jaw support block assembly to adjust the unit for the proper tubing size.
- With A/C power and compressed air attached to the expander, actuate the electric foot switch which will activate the expander. Adjust the expander lower jaw to the position you want using the **Thumb Wheel Knob**. Note that the jaws may be set to remain in the “open” position using the toggle switch noted in **Figure 2.3.1**, and triggering the foot pedal. Make sure the toggle switch is returned to the “off” position, or the jaws will remain open.
- Locate the lower expander jaw position for your tubing size using the larger *thumb-wheel*.

(This adjustment may require fine tuning depending on your tubing I.D., O.D., Durometer or material. It is recommended you note or log the jaw gap settings for future applications, or usage.)

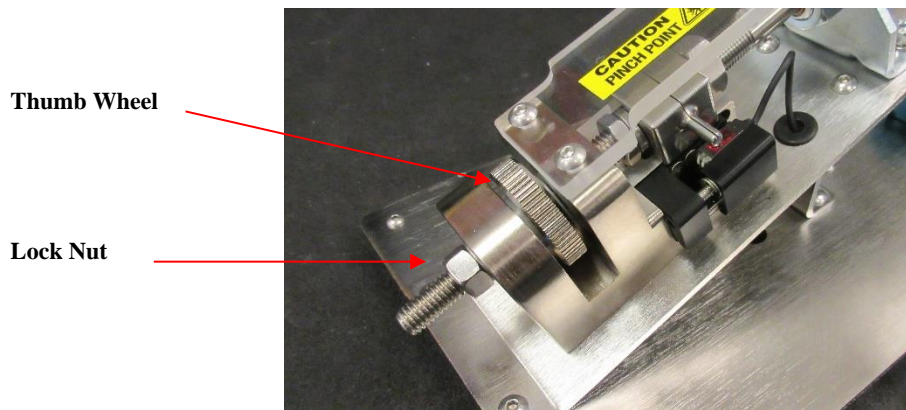

Figure 3.1.1: Jaw Adjustment

- Next, tighten the *thumb-wheel* against the lower mounting block and secure in place using the 9/16” wrench to snug the 3/8” hex nut against the bottom of the lower jaw support block assembly. Be careful that you do not over tighten the nut.

3.1.A Using the Jaw Hold-Open Feature

- A Jaw Hold-Open switch has been installed on the tubing expander. This makes setting the gap between the jaws much simpler.
 - 1) With the toggle switch in the “ON” position, flip the jaw hold-open switch to the “ON” position (UP).

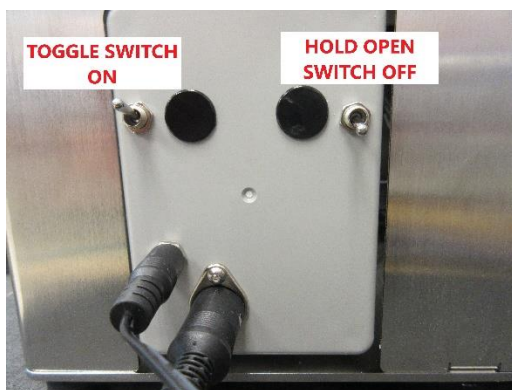

Figure 3.1.A.1

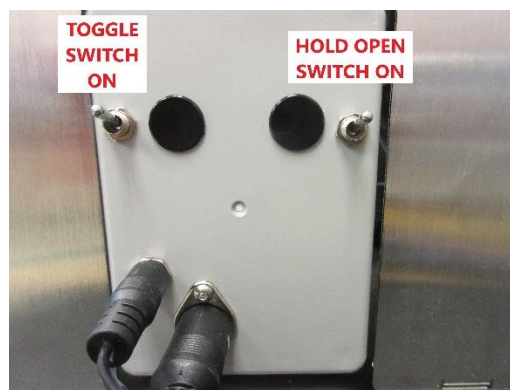

Figure 3.1.A.2

- 2) Use the foot pedal to trigger the cycle. The upper jaw will retract and remain open.

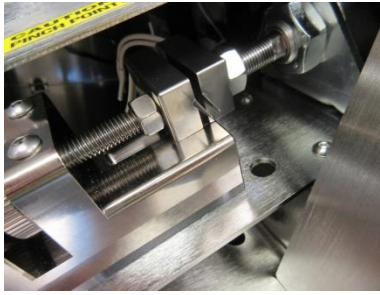

Figure 3.1.A.3

- 3) Flip the jaw hold-open switch to “OFF” position (DOWN) and the upper jaw will return to the non-expanded position.

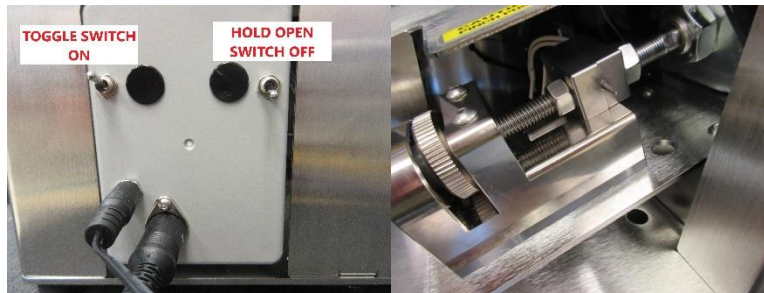

Figure 3.1.A.4

Figure3.1.A.5

3.2 *Setting the Time Delays*

- The CRD201 expansion operation is designed to let the operator expand each piece of tubing twice. After the first expansion, the jaws will close and the operator rotates the tube 90 degrees and the jaws will automatically expand again. This ensures that the tubing is expanded in a uniform fashion, and not deformed in only one direction. To assist with this 2-step expansion operation, there are two time delay relays on the unit.
 - **Expansion Time** – This setting adjusts the rate (0.5-5.0 seconds) at which the tube expansion occurs. The rate at which the tube is expanded is critical to prevent tearing. Some stiffer tubing might need a longer expansion time, while softer tubing can be expanded rapidly.
 - **Interval Time** – This setting adjusts the time delay rate (0.5-5.0 seconds) at which the jaws will cycle. It is adjusted to allow the operator to rotate the tubing 90 degrees at a comfortable pace between expanding.
- Remove the hole plugs with a screwdriver on the rear cover to gain access to the Time Delay adjustment pots. *Figure 3.2.1*



Figure 3.2.1 Removing Access Hole Plugs

- Using a small Phillips drive screwdriver adjust the Time Delay relays. *Figure 3.2.2* Turn the adjustment screw clockwise (to the right) to increase the delay. Turn the adjustment screw counter-clockwise (to the left) to decrease the delay.



Figure 3.2.2 Adjusting the Expansion Time Pot

- *Figure 3.2.3* below shows the CRD201 with the rear cover removed, as well as the location of both time delay adjustments on the time delay relay:

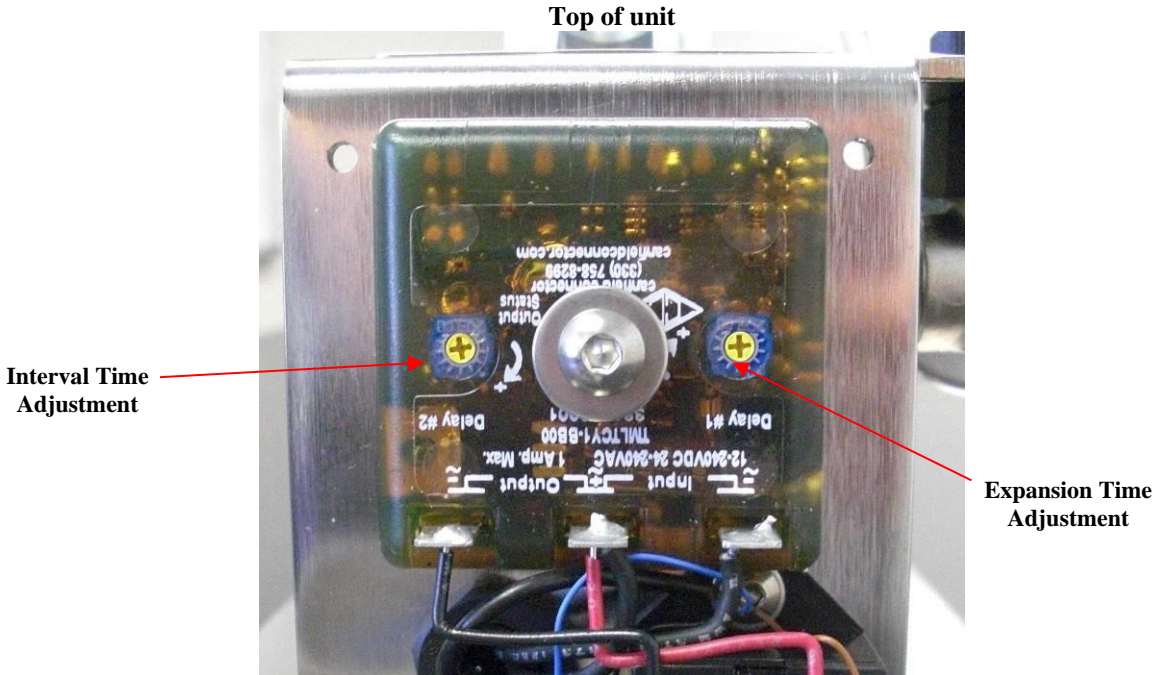

Figure 3.2.3

3.3 Expanding Operation

- To adjust the jaws for the size tubing to be expanded you need to loosen the **3/8” hex nut (Lock Nut.)**
- With A/C power and compressed air attached to the expander, actuate the electric foot switch which will activate the expander. Adjust the expander lower jaw to the position you want using the **Thumb Wheel Knob**. Note that the jaws may be set to remain in the “open” position using the toggle switch noted in **Figure 3.3.1**, and triggering the foot pedal. Make sure the toggle switch is returned to the “off” position, or the jaws will remain open.
- Turning the **Thumb Wheel** clockwise will increase the jaw expansion size, counter clockwise will decrease the jaw expansion size. This adjustment may require fine tuning depending on your tubing I.D., O.D., durometer and/or material.
- Once you have the expansion size you want tighten the **Lock Nut** to secure the adjustment.
- Place the tube over the ends of **both** expander jaws and hold firmly in place.
- Actuate the Tube Expander by pressing the electric foot switch.

- Rotate the tubing 90 degrees on the jaws and actuate the Tube Expander by pressing the electric foot switch again. **Failure to do so may result in uneven expansion and/or damaged tubing!**

Note: Several expanding actions may be necessary to effectively expand the end of the tube for the fitting/connector to slide in. Each time you expand the tubing remember to rotate the tubing 90 degrees on the jaws.

- Quickly insert the component or tube connector before the tubing regains its original size.

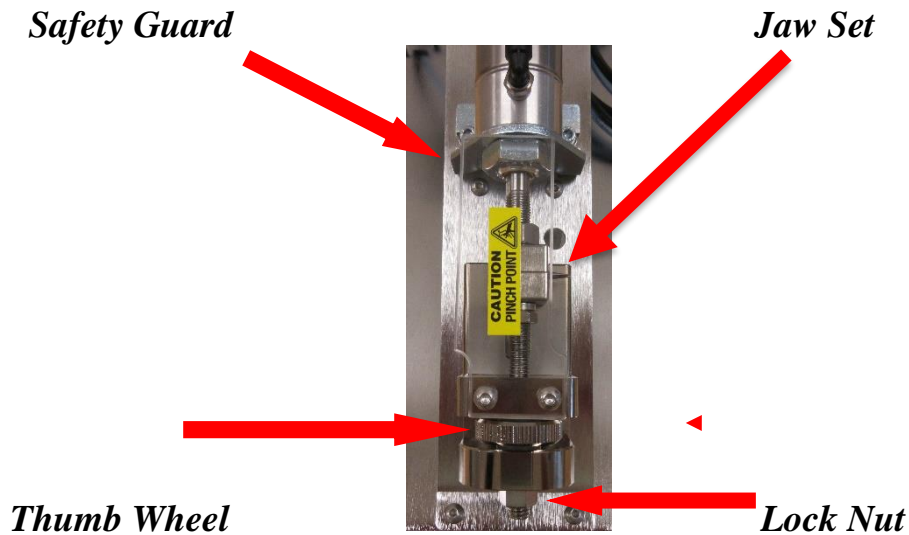

3.4 *Jaw installation and removal*

- Tools required are: 3/8" open ended wrench, 9/16" open ended wrench, 11/16" open ended wrench, 3mm, 4mm and 3/32nd hex wrench
- Remove jaw guard by removing two 5x10mm screws using a 3mm hex wrench.
- Turn the thumb wheel clockwise until the cylinder shaft is fully extended in the jaw block channel. **Figure 3.4.1**

Cylinder shaft shown fully extended and retracted in jaw block channel



Figure 3.4.1 – Fully extended

Fully retracted

- Using a 3/8” open end wrench to hold the cylinder on the flats and a 11/16” open end wrench break the upper jaw nut loose by turning counter clockwise. *Figure 3.4.2.*
- Using a 9/16” open end wrench break the lower jaw nut loose while holding the thumb wheel, keeping the threaded rod from rotating. *Figure 3.4.3*



Figure 3.4.2

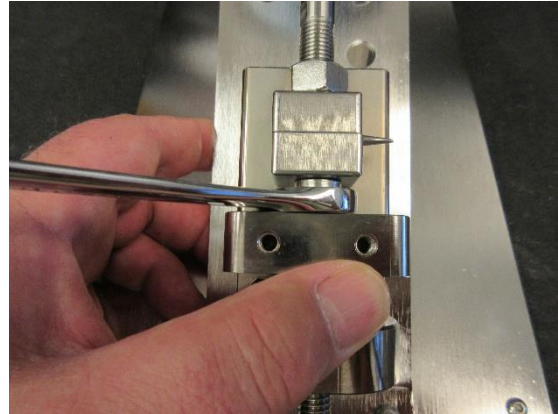

Figure 3.4.3

- Now remove the two 5x12mm screws holding the front cylinder mount bracket using a 4mm hex wrench. *Figure 3.4.4.* Rotate the cylinder backwards until it stops in the semi-vertical position. *Figure 3.4.5*

Remove two 5x12mm screws

Cylinder semi-vertical position

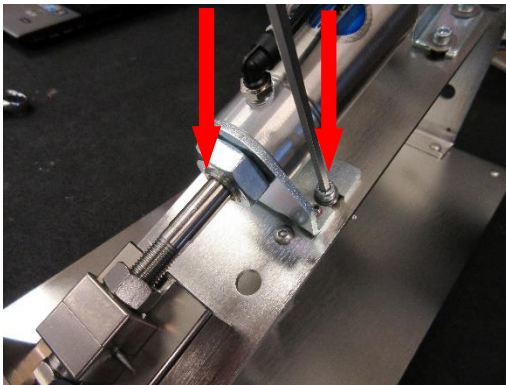

Figure 3.4.4



Figure 3.4.5

- Rotate the upper jaw by hand counter clockwise until removed.
- **Important note: when screwing upper jaw onto cylinder shaft it is important to only screw the jaw 2/3 to 3/4 of the way on. Any farther and the jaw may slip off the jaw block when the cylinder is retracted.**

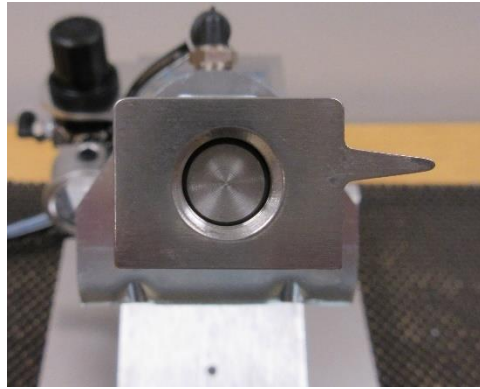

Figure 3.4.6: Jaw threaded 2/3-3/4 onto shaft

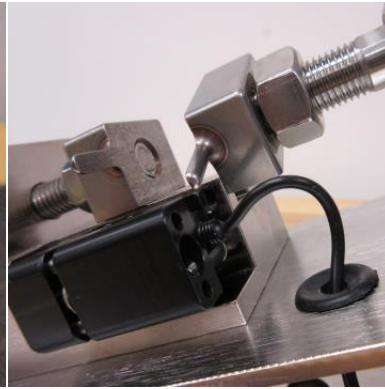

Figure 3.4.7: Jaw threaded on too far and has slipped off jaw block

- Remove the *lock nut* and turn threaded rod by hand and rotate rod counter clockwise while holding the lower expander jaw until the jaw is removed. *Figure 3.4.8*

Rotate rod while holding lower jaw

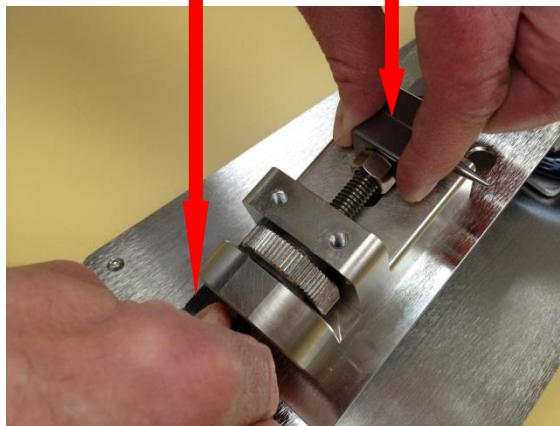

Figure 3.3.8

- Select replacement jaw set and assemble them in the reverse order of operations.
- **Note:** If the cylinder shaft won't retract when being cycled the adjustment of both set screws on the front cylinder mount bracket will need to be adjusted. To make the adjustment you must first loosen the two 5x12mm screws using a 3mm hex wrench (*Figure 3.4.9*) and then by adjusting the two set screws using a 3/32nd hex wrench. *Figure 3.4.10*. Now tighten the two 5x12mm screws and ensure jaw alignment.

5x12 mm screws (One per side)

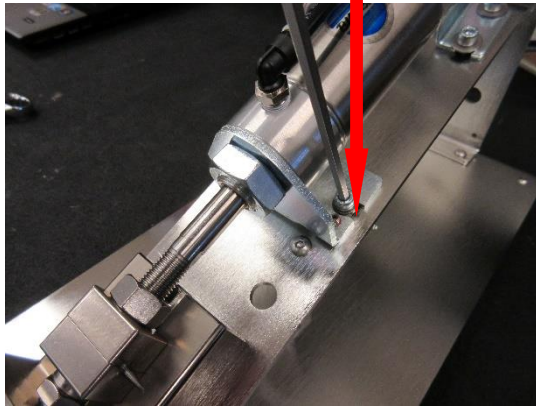

Figure 3.4.9

Set Screw (One per side)

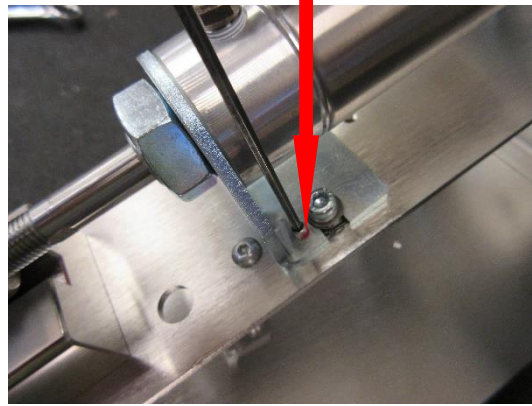

Figure 3.4.10

4.0 Troubleshooting

Operating Error	Action
Unit does not operate.	<ol style="list-style-type: none">1. Check the facility air connection.2. Check all air hose connections on the unit.
Jaws do not expand.	<ol style="list-style-type: none">1. Ensure there are no obstructions keeping the jaws from expanding.2. Completely depress the foot pedal to actuate.3. Ensure the toggle switch is set to the on setting.
Flexible tubing is splitting/tearing.	<ol style="list-style-type: none">1. Ensure the tubing being expanded does not exceed the recommended durometer.2. Ensure the lower jaw has been adjusted correctly for the tubing inside diameter (I.D.).3. Verify facility air supply psi or unit pressure adjustment.4. Increase the expansion time setting for a more gradual expansion.

5.0 Maintenance

5.1 Periodic Cleaning (annually)

- Wipe down outer surfaces with alcohol, septihol or mild detergents as required.

5.2 Tools List

- 3/8", 9/16" and 11/16" open ended wrenches.
- 3/32", 3mm and 4mm hex wrenches (T-handle preferred).
- Small standard screwdriver, #0 Phillips screwdriver.

6.0 Product Specifications

Unit Weight	8 LBS / 3.5 KG
Overall Dimensions	15 in. (38cm) lg. x 7 in. (18cm) w. x 7 in. (18cm) ht.
Minimum Facility Air Supply	100 PSI
Unit Air Regulator Setting	80-120 PSI

7.0 Durometer Scale

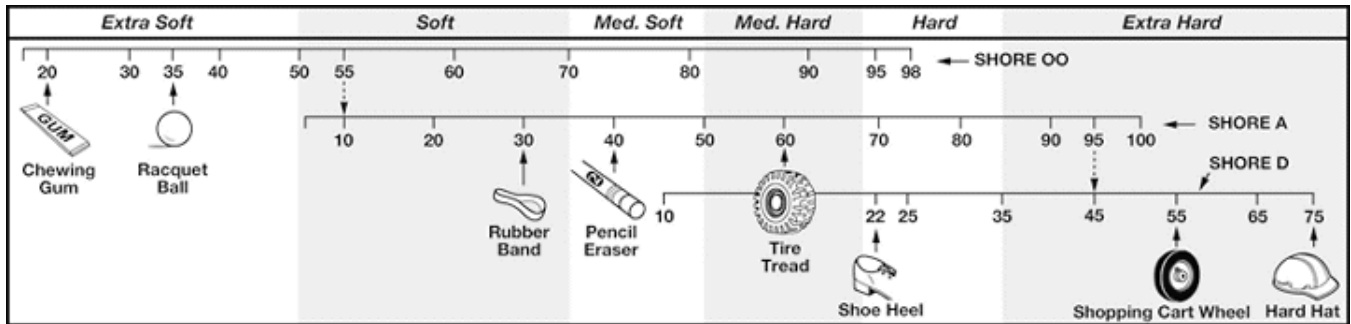

8.0 Wiring Schematic

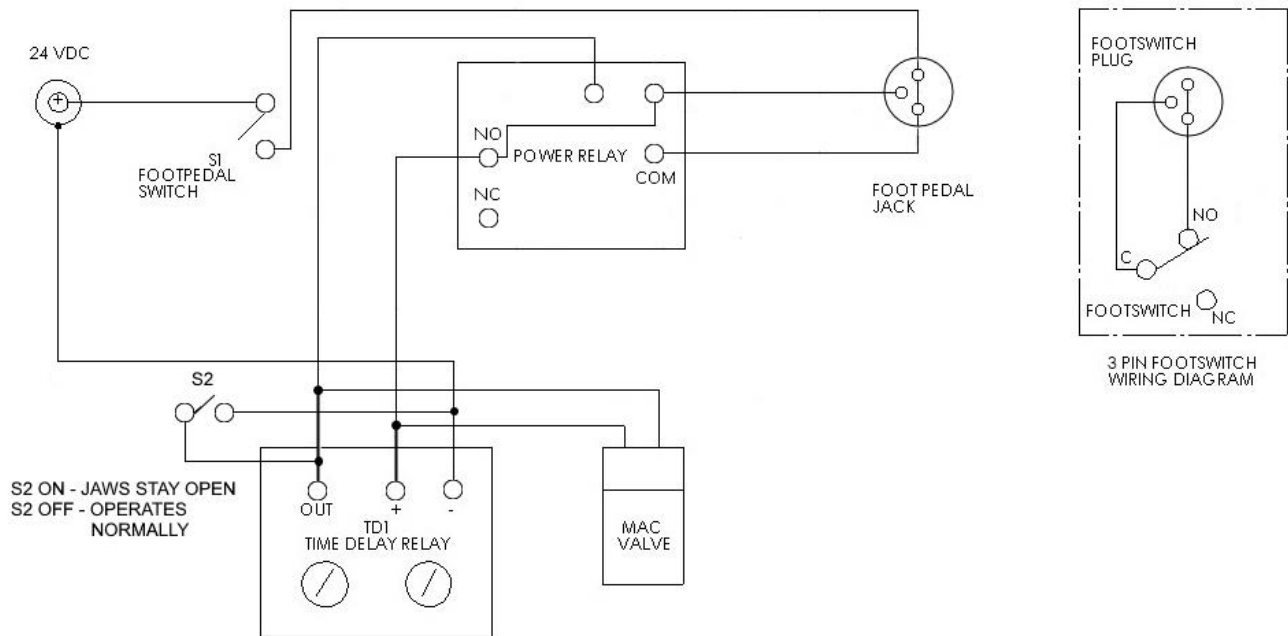

WIRING DIAGRAM
CRD 201 TD EXPANDER

**Note: Schematic drawings are provided for troubleshooting only—
not for modifying the machine in any way!**

9.0 Parts List

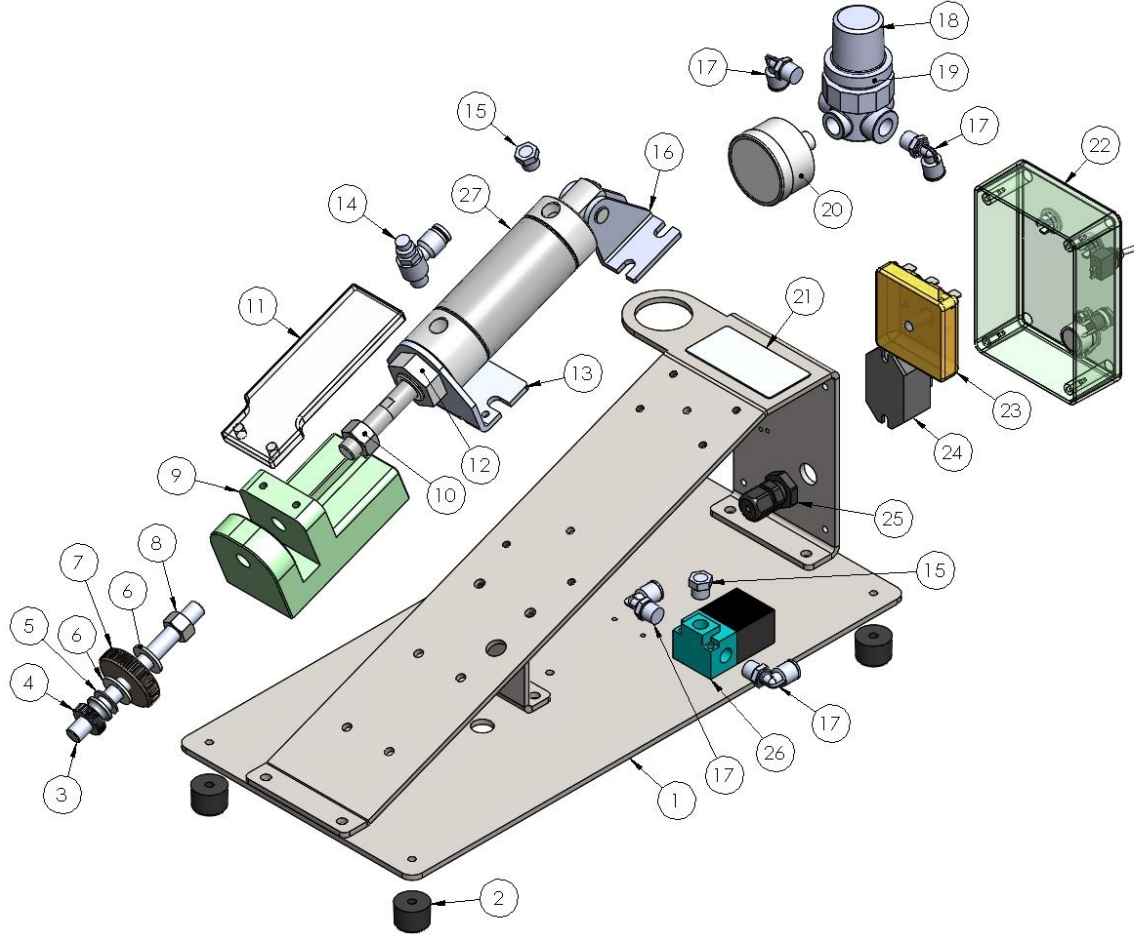

Item	Part Number	Description	Item	Part Number	Description
1	CD002-002	Base Assembly	15	P00022	Muffler
2	P00026	Rubber Foot	16	P00027	Rear Cylinder Bracket
3	P00057	Threaded Rod	17	P00063	90° Elbow Fitting
4	CD002-063	Thumb Nut	18	P00066	Regulator
5	P00056	Steel Flat Washer	19	P00067	Regulator Nut
6	P00086	Nylon Flat Washer	20	P00280	Pressure Gauge
7	CD002-137	Thumb Knob	21	CD001-0027	Nameplate
8	P00059	3/8-16 Hex Nut	22	P00275	Poly Case
9	CD002-138	Lower Jaw Block	23	P00264	Time Delay Relay
10	P00058	7/16-20 Hex Nut	24	P00265	Relay
11	CD002-055	Jaw Guard	25	P00094	Tightcord Grip Bulkhead
12	P00085	3/4-16 Hex Nut	26	P00108	3-Way MAC Valve
13	CD002-116	Front Cylinder Bracket	27	P00054	Air Cylinder
14	P00141	Flow Valve			

10.0 Warranty

10.1 Warranty

The manufacturer warrants the product manufactured by it, when properly installed, operated, applied and maintained in accordance with the procedures and recommendations outlined in the manufacturer's operation manual, to be free from defects in material or workmanship for a period as specified below, provided such defect is discovered and brought to the manufacturer's attention within the stated warranty period.

The manufacturer will repair or replace any product or part determined to be defective by the manufacturer within the warranty period, provided such defect occurred in the normal service and not as a result of misuse, abuse, neglect or accident. Normal maintenance items requiring routine replacement are not warranted. The warranty covers parts and labor for the warranty period unless otherwise specified. Repair or replacement shall be made at the factory or the installation site, at the sole discretion of the manufacturer. Any service performed on the product by anyone other than the manufacturer must first be authorized by the manufacturer.

Unauthorized service voids the warranty and any resulting charge or subsequent claim will not be paid. Products repaired or replaced under warranty shall be warranted for the unexpired portion of the warranty applying to the original product.

The foregoing is the exclusive remedy of any buyer of the manufacturer's product. The maximum damages liability for the manufacturer is the original purchase price of the product or part.

THE FOREGOING WARRANTY IS EXCLUSIVE AND IN LIEU OF ALL OTHER WARRANTIES, WHETHER WRITTEN, ORAL, OR STATUTORY, AND IS EXPRESSLY IN LIEU OF THE IMPLIED WARRANTY OF MERCHANTABILITY AND THE IMPLIED WARRANTY OF FITNESS FOR A PARTICULAR PURPOSE. THE MANUFACTURER SHALL NOT BE LIABLE FOR LOSS OR DAMAGE BY REASON OF STRICT LIABILITY IN TORT OR ITS NEGLIGENCE IN WHATEVER MANNER INCLUDING DESIGN, MANUFACTURE OR INSPECTION OR THE EQUIPMENT OR ITS FAILURE TO DISCOVER, REPORT, REPAIR, OR MODIFY LATENT DEFECTS INHERENT THEREIN.

THE MANUFACTURER, HIS REPRESENTATIVE OR DISTRIBUTOR SHALL NOT BE LIABLE FOR LOSS OF USE OF THE PRODUCT OR OTHER INCIDENTAL OR CONSEQUENTIAL COSTS, EXPENSES, OR DAMAGES INCURRED BY THE BUYER, WHETHER ARISING FROM BREACH OF WARRANTY, NEGLIGENCE OR STRICT LIABILITY IN TORT.

The manufacturer does not warrant any product, part, material, component, or accessory manufactured by others and sold or supplied in connection with the sale of manufacturer's products.

10.2 Warranty Period

Parts and labor are for ninety (90) days from the date of shipment from the factory. Freight to the factory on units that the manufacturer requests to be returned shall be paid by the purchaser, all return freight to be paid by the manufacturer; means of transportation to be specified by the manufacturer.

For additional information contact: www.cleanroomdevices.com

Clean Room Devices, Inc.
10855 Dover Street, Suite 100
Westminster, CO 80021
303-438-0853