

REVISIONS				
ZONE	REV.	DESCRIPTION	DATE	APPROVED
	A	INITIAL RELEASE	11/26/13	MSC
	B	SHIFTED ELECTRICAL OUTLET DOWN BY 2"	1/19/14	MSC
	C	ADDED NOTE THAT ELECTRICAL OUTLET IS TO BE ON CLEAN ROOM SIDE	2/5/14	MSC
	D	ADJUSTED OPENING LOWER EDGE TO 36" ELEVATION	4/8/14	MSC
	E	ADDED SECTION VIEW A-A	8/18/16	MSC

Wall thickness must be 4 7/8" +/- 1/8"

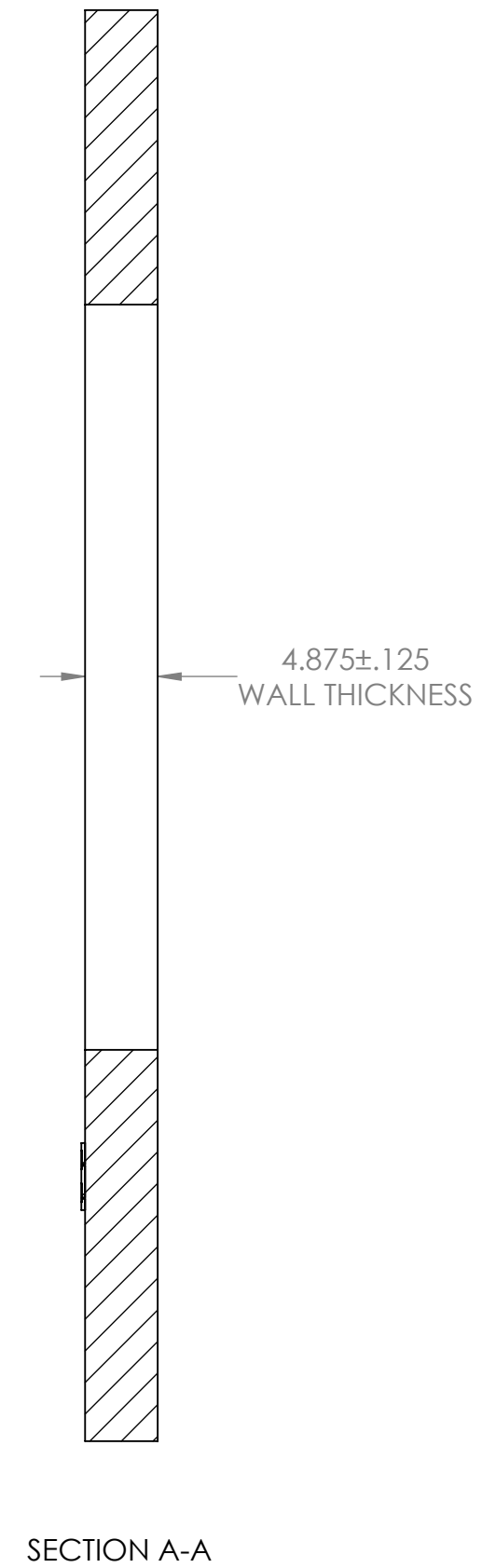
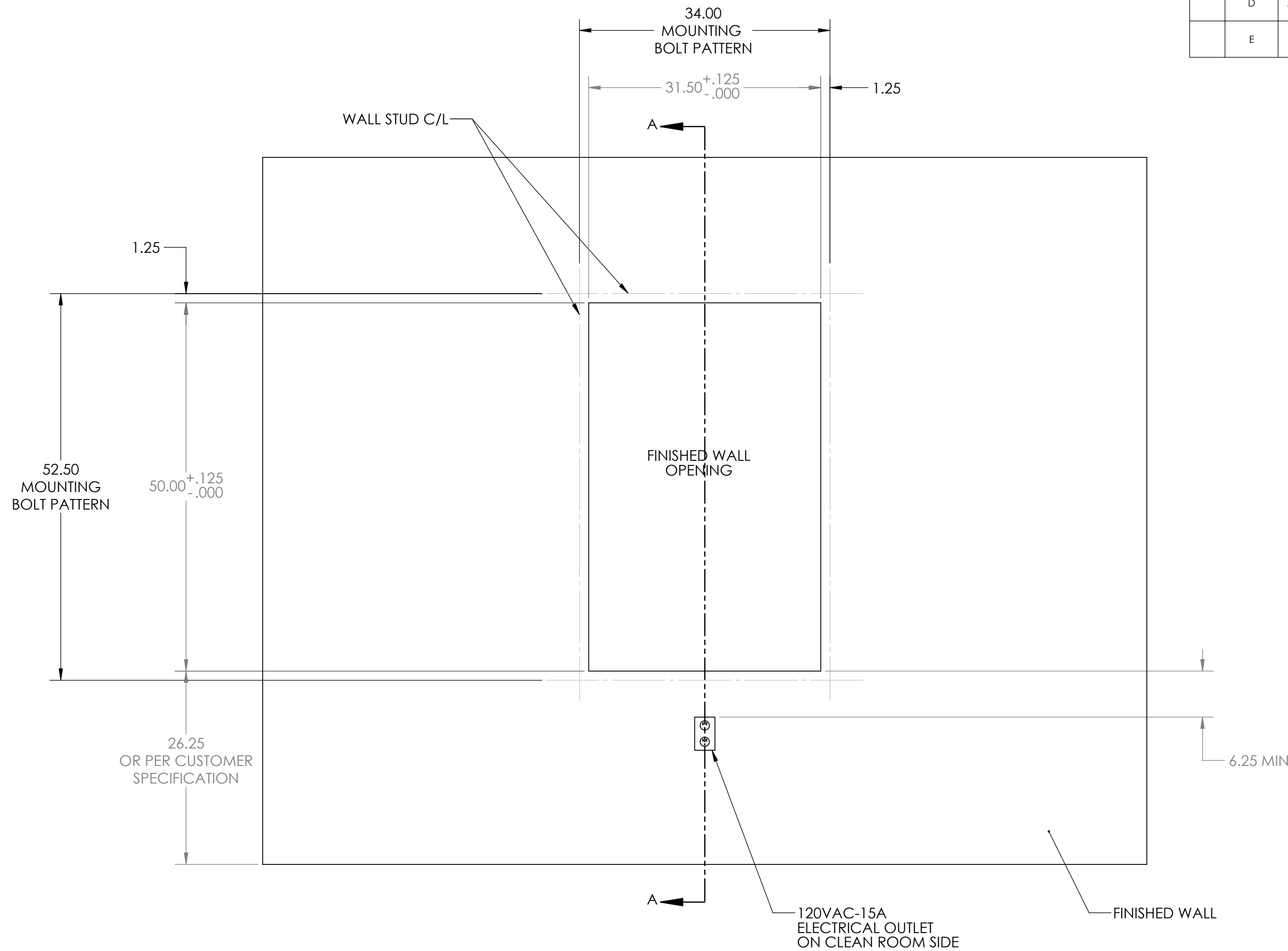

- NOTES:
1. WALL STUDS SHOULD BE CENTERED ON THE BOLT PATTERN CENTERLINES TO SUPPORT THE PASS-THRU WINDOW
  2. 120VAC-15A ELECTRICAL OUTLET IS REQUIRED TO POWER THE UNIT
  3. 6-FOOT POWER CORD IS SUPPLIED WITH THE WINDOW
  4. OVERALL WALL THICKNESS SHOULD BE 4.875 +/- .125"

**PROPRIETARY AND CONFIDENTIAL**  
 THE INFORMATION CONTAINED IN THIS DRAWING IS THE SOLE PROPERTY OF CLEAN ROOM DEVICES, LLC. ANY REPRODUCTION IN PART OR AS A WHOLE WITHOUT THE WRITTEN PERMISSION OF CLEAN ROOM DEVICES, LLC IS PROHIBITED.

UNLESS OTHERWISE SPECIFIED:		NAME	DATE	CLEAN ROOM DEVICES, LLC
DIMENSIONS ARE IN INCHES		DRAWN	MSC	
TOLERANCES:		CHECKED		TITLE: <b>FINISHED WALL OPENING, CRD325</b>
FRACTIONAL ±1/16		ENG APPR.		
ANGULAR: MACHINED ±0.5° BEND ±2°		MFG APPR.		
TWO PLACE DECIMAL ±.01 THREE PLACE DECIMAL ±.005		Q.A.		SIZE DWG. NO. REV <b>C 325-002 E</b>
INTERPRET GEOMETRIC TOLERANCING PER: ANSI Y14.5		COMMENTS:		SCALE: 1:12 WEIGHT: SHEET 1 OF 1
MATERIAL		SEE NOTES		
FINISH		SEE NOTES		
NEXT ASSY	USED ON			
APPLICATION		DO NOT SCALE DRAWING		